



**LFT483** LT. COMMERCIAL • 2YR  
**LED 2x4 TROFFER 3-T8**  
INDOOR FIXTURE

**FEATURES**

- Uses 30% less energy than a linear fluorescent troffer
- Die formed, and rigidly fabricated
- Smooth edges for easy handling and no exposed fasteners
- Clear prismatic acrylic diffuser
- Door hinges are on either side for easy re-lamping
- Positive locking cam action latches with matching finish
- LED ready with non-shunted sockets
- Exposed T-grid ceiling and recessed ceiling mount

**APPLICATION**

Ideal for offices, retail, commercial buildings and work areas.

**ELECTRICAL**

|                          |          |
|--------------------------|----------|
| Lamp Type (not included) | T8       |
| Number of Lamps          | 3        |
| Voltage                  | 120-277V |

**ENVIRONMENT**

|                           |             |
|---------------------------|-------------|
| Operating Temperature     | -4° ~ 122°F |
| Suitable Location         | <b>DAMP</b> |
| Ingress Protection Rating | IP40        |

**LIFESPAN**

|                  |          |
|------------------|----------|
| Warranty (Years) | <b>2</b> |
|------------------|----------|

**CONSTRUCTION**

|                     |                               |
|---------------------|-------------------------------|
| Housing             | 24 Gauge Steel                |
| Base / Power Supply | Hard Wired                    |
| Finish              | High Gloss Baked White Enamel |

**QUALIFICATIONS**

|                      |       |
|----------------------|-------|
| Manufacturer Model # | 55046 |
|----------------------|-------|



*Manufactured by P.Q.L., Inc. • \*Operating temperature may vary depending on lamps used.*

# LFT483 LT. COMMERCIAL • 2YR LED 2x4 TROFFER 3-T8



## DIMENSIONS (Inches)

|                |      |
|----------------|------|
| Length         | 48"  |
| Width/Diameter | 24"  |
| Height         | 3.3" |
| Weight (Lbs)   | --   |

Line drawings may not be to scale and are for general reference only.

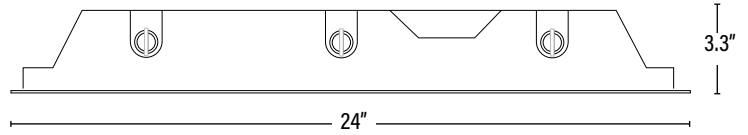

## PACKAGING

|                   |              | UPC          | DIMENSIONS (LxWxH) | GROSS WEIGHT (Lbs) |
|-------------------|--------------|--------------|--------------------|--------------------|
| Master Carton     | 1            | 811768025217 | --                 | --                 |
| Country of Origin | China        |              |                    |                    |
| HS Tariff         | 9405.10.6020 |              |                    |                    |

## ORDERING

| ITEM#  | DESCRIPTION                 | CASE |
|--------|-----------------------------|------|
| LFT483 | 2X4 TROFFER FOR 3-T8 BYPASS | 1    |

Manufactured by P.Q.L., Inc. - Manufacturer Model # 55046

PERFORMANCE DATA

PACKAGING